

TOSHIBA INSTALLATION MANUAL

To Qualified Installer in Installation Work and Service

Occupancy sensor kit

(for Compact 4-Way cassette type)

Model: TCB-SIR41UMP-E

- Thank you for purchasing Occupancy sensor kit for TOSHIBA air conditioners.
 - Read this manual carefully for correct installation of the Occupancy sensor before starting work.
 - After the installation is completed, execute a test run to check for normal operation and explain how to use and maintain the Occupancy sensor to the customer according to the Operations Manual.
- Ask the customer to keep this manual with the Operations Manual.

Observe the safety precautions described in the Operations Manual of the Occupancy sensor, Installation Manual and Operations Manual of the 4-way cassette type air conditioner (indoor unit), or the installation manual supplied with the ceiling panel.

ACCESSORIES

Part Name	Q'ty
Occupancy sensor	1

Part Name	Q'ty
Operations Manual	1
Installation Manual (this manual)	1
CD-ROM	1

HOW TO INSTALL THE OCCUPANCY SENSOR

Install the Occupancy sensor in correct orientation, since the Occupancy sensor can be installed at only one corner as shown in (Fig. 1).

1. Remove the adjust corner cap at the corner where the Occupancy sensor is to be installed. (Fig. 2)
- Turn counterclockwise the screw of the suction port corner of the ceiling panel to loosen it.
- Slide the adjust corner cap toward direction of the arrow mark (1) and then remove it.

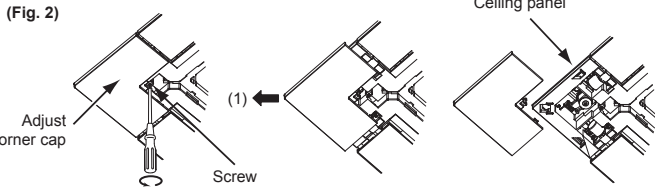
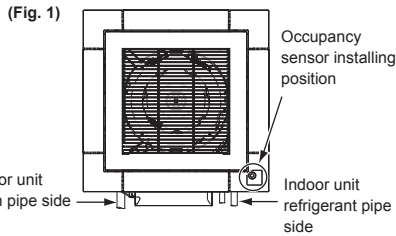

2. Pass the occupancy sensor lead wire through the hole in the ceiling panel. (Fig. 3)

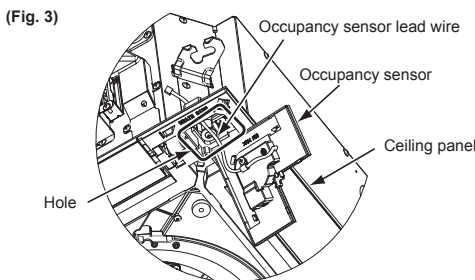

3. Attach the Occupancy sensor to the ceiling panel and fix it by tightening screw at the ceiling panel corner. (Fig. 4)
- Align the clips on the back of the occupancy sensor with the holes in the corners of the panel and press them into the holes by pressing in direction (1) and sliding the cap in direction (2).
- Take care that the wire is not pinched against the occupancy sensor at this time.

(Fig. 4)

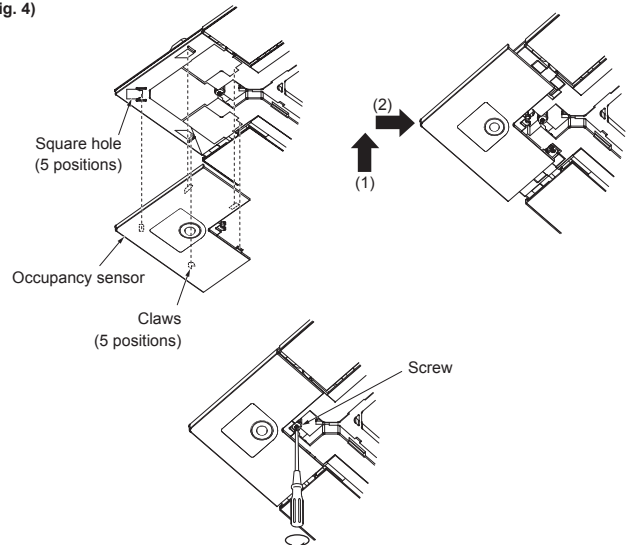

- Check that none of the clips are out of alignment.

HOW TO WIRING THE OCCUPANCY SENSOR

Remove the electrical control box cover and connect the occupancy sensor lead wire to the connector (CN214) on the P.C. board inside the electrical control box.

- The occupancy sensor lead wire is secured to the electrical control box by two clamps.
- Pay attention that the occupancy sensor lead wire is not pinched by the ceiling panel.

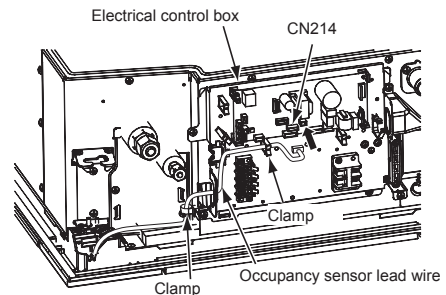

CODE NO. (DN) SETTING

Wired remote controller (RBC-AMS5*E*)

Perform the advanced settings for the air conditioner.
Carry out the setting operation while the indoor unit is stopped.
(Turn off the air conditioning unit before starting the setting operation.)



1. Push the [MENU] button to display the menu screen.
2. Push and hold the [MENU] button and the [V] button at the same time to display the "Field setting menu".
Push and hold the buttons for more than 4 seconds.

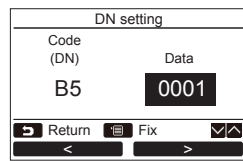
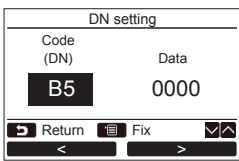

3. Push the [▲]/[▼] button to select "7. DN setting" on the "Field setting menu" screen, then push the [Set] [F2] button.
The fan and louver of the indoor unit operate. When the group control is used, the fan and louver of the selected indoor unit operate.
Move the cursor to select "DN Code" with the [←] [F1] button, then set "B5" with the [▲]/[▼] button.
Move the cursor to select "Data" with the [→] [F2] button, then set "0001" with the [▲]/[▼] button.

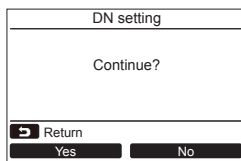

4. Push the [MENU] button to set the other DN codes. After "Continue?" is displayed on the screen.
5. Push the [No] [F2] button to finish the setting operation.
"Σ" appears on the screen for a while, then the screen returns to the "Field setting menu" screen.
Pushing the [No] [F2] button displays the unit selection screen when the group control is used. Push the [CANCEL] button on the unit selection screen to finish the setting operation. "Σ" appears on the screen for a while, then the screen returns to the "Field setting menu" screen.
6. Push the [CANCEL] button to return.

Occupancy sensor CODE NO. (DN) setting

Wired remote controller (RBC-ASCU*)

Perform the advanced settings for the air conditioner.
Carry out the setting operation while the indoor unit is stopped.
(Turn off the air conditioning unit before starting the setting operation.)

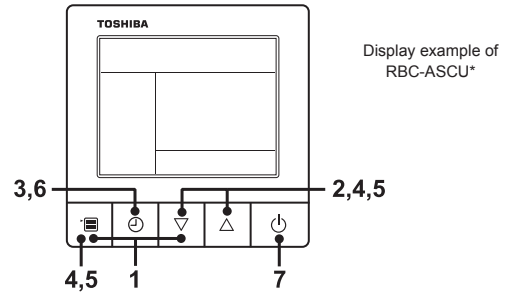

1. Push and hold [MENU] menu button and [▼] setting button simultaneously for 10 seconds or more.
2. Each time [▼] [▲] setting button is pushed, indoor unit numbers in the group control change cyclically.
Select the indoor unit to change settings.
3. Push [OFF] OFF timer button to confirm the selected indoor unit.

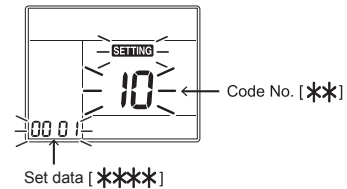

4. Push the menu button to make Code No. [**] flash. Change Code No. [DN Table] with [▼] [▲] setting button.
5. Push the menu button to make Set data [****] flash. Change Set data [DN Table] with [▼] [▲] setting button.
Push OFF timer button by doing so, the setup is completed.
6. Push OFF timer button by doing so, the setup is completed.
• To change other settings of the selected indoor unit, repeat from Procedure 4.
7. When all the settings have been completed, push [ON/OFF] ON/OFF button to determine the settings.
"SETTING" flashes and then the display content disappears and the air conditioner enters the normal stop mode. (The remote controller is unavailable while "SETTING" is flashing.)

DN Code Table

DN	Item	Description		Factory setting
B5	Occupancy sensor	0000 : None	0001 : Occupancy sensor provided	0000 : None
B6	Occupancy sensor setting (Cycle period)	0000 : Not Activate 0002 : 60min 0004 : 120min	0001 : 30min 0003 : 90min 0005 : 150min	0002 : Enable 60min
B7	Occupancy sensor operation at absent time	0000 : Standby	0001 : Operation stop	0000 : Standby

ABOUT THE OCCUPANCY SENSOR

- Sometimes the sensor may not detect people even when they are present if their movements are small.
- If something having a difference in temperature with the surroundings moves, the sensor may detect people as present even if they are not present.
- A wired remote controller (RBC-AMS5*E*) is required to use an occupancy sensor.
- Be sure to install an occupancy sensor in all indoor units if using group operation.

LIST OF SEPARATELY AVAILABLE PRODUCTS THAT CANNOT BE USED WITH THE OCCUPANCY SENSOR

The following separately available products cannot be used together with the Occupancy sensor.

Product name	Model
Wireless receiver kit	RBC-AXU31UMP-E, RBC-AXU31UMPB-E