

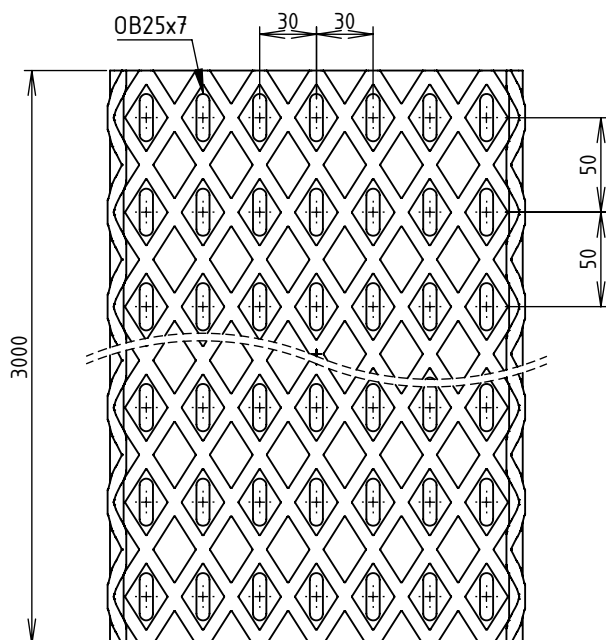

CODE	REF.	LARG./ WIDTH (mm)	e tdb / bpt (mm)	MATIERE / MATERIAL	POIDS NET / NET WEIGHT (Kg)	POIDS NET / NET WEIGHT (Kg/m)	COLISAGE / PACKING (m)	CPS / SPL (daN/m)		
								Portée / Range (m)		
								1.50	2.00	2.50
MVX0023LD	95 BRX80	93.8	0.6	BOBINE 0.60 DC01 + GAC	3.978	1.326	18	80	60	33
MVX0023LF	155 BRX80	153.8	0.6	BOBINE 0.60 DC01 + GAC	4.838	1.613	12	80	60	33
MVX0023LH	215 BRX80	213.8	0.7	BOBINE 0.70 DC01 + GAC	6.533	2.178	12	90	70	50
MVX0023LL	305 BRX80	303.8	0.7	BOBINE 0.70 DC01 + GAC	8.013	2.671	6	100	75	60
MVX0023LP	395 BRX80	393.8	0.9	BOBINE 0.90 DC01 + GAC	11.918	3.973	6	107*	80*	61*
MVX0023LU	515 BRX80	513.8	0.9	BOBINE 0.90 DC01 + GAC	14.394	4.798	6	112,5*	85*	64*
MVX0023LX	605 BRX80	603.8	0.9	BOBINE 0.90 DC01 + GAC	16.253	5.418	6	112,5*	85*	64*

*: Valeur de CPS indiquée avec installation d'un couvre-joint

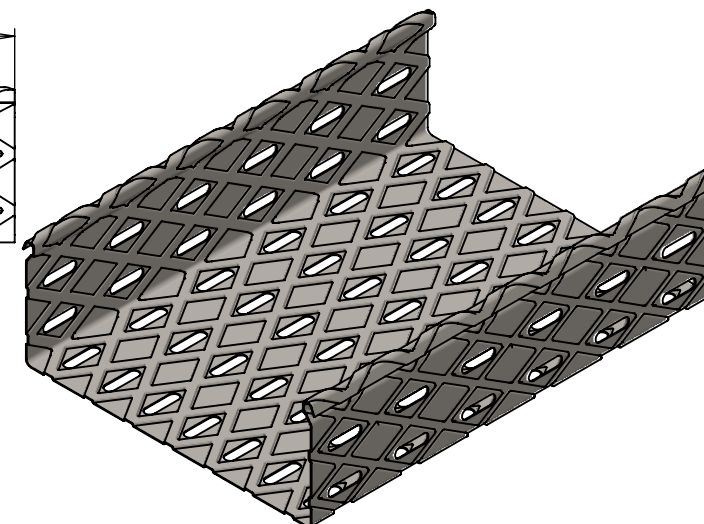
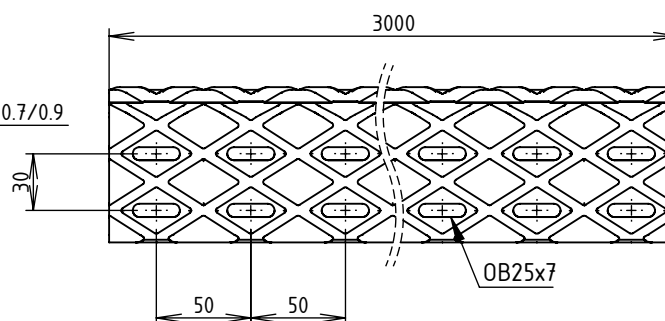
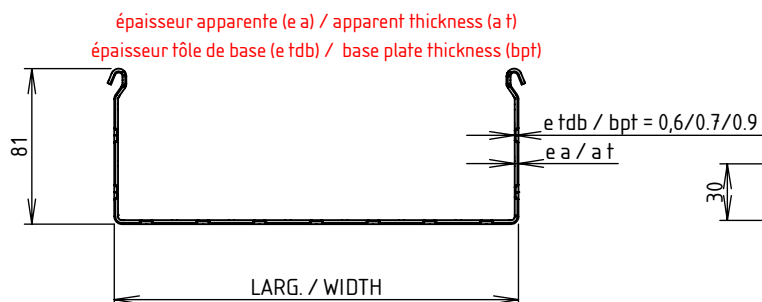

Matière/Material - NF EN 10130/10131
 Revêtement/Coating: GAC/HDG - Galvanisation à chaud par immersion selon NF EN 1461
 Dimensionnel garanti avant galvanisation
 Hot dip galvanised by immersion according to NF EN 1461
 Dimensional guaranteed before galvanizing
 CPS/SPL: Charge pratique de sécurité/Safety Pratical Load - NF EN 61537

 	DESIGNATION:		CC BRX80 GAC		
	Propriété GEWISS France - Toute reproduction et utilisation tierce requièrent l'accord écrit de GEWISS France				
Usine de Liernais BP 1 21430 LIERNAIS TEL.: 03.80.90.51.00 FAX: 03.80.84.43.66	DESSINE PAR:	BERGEROT D.	VERIFIE PAR:	LEGUY C.	FORMAT A4 H
	DATE:	12/01/2023	ECHELLE:	1:4	
	N°:	MVX0023LD à MVX0023LX_01			